

CUSTOMER COPY

Notes:

- Material:
Insulator: LCP+30% G.F., UL 94V-0 rated, Color Black.
Contact: Phosphor Bronze Thickness=0.20mm.
Metal cover: stainless steel sheet. thickness=0.20mm.
- Plating:
Contact Area: Gold Plating over 1.27um(50u") min Ni underplate.
Soldering area: plated 2.54um(120u")min Tin 100% over 1.27um(50u") min.Ni under plating overall.
- unless otherwise specified,all tolerance follow drawing common standard.
- The dimensions with "■" mark indicates critcal dimensions.
- Part NO.

SDMA-71001-00X00

└ Au contact area/solder in soldering zone.

B: Gold flash/120u" Tin, 100%.

E: 5u" Au/120u" Tin, 100%.

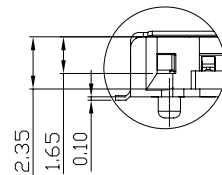
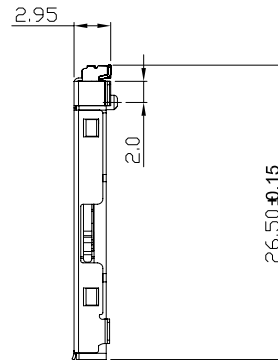
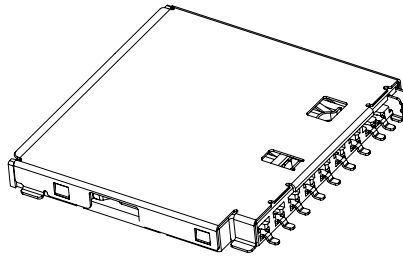
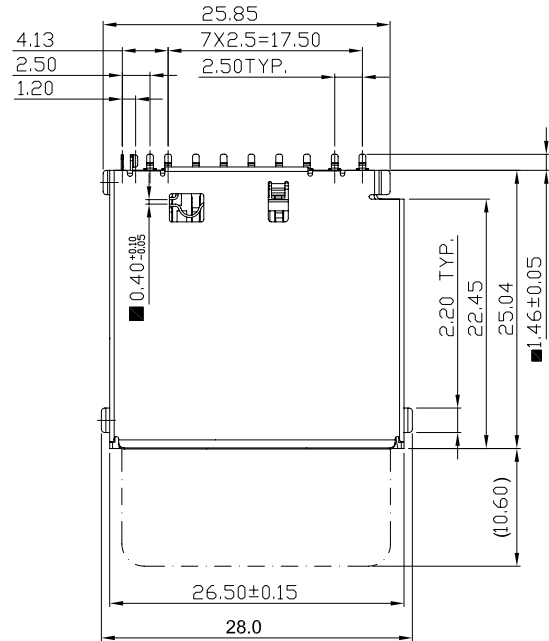

View A
SCALE 2:1

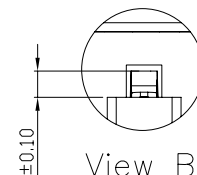

View B
SCALE 4:1

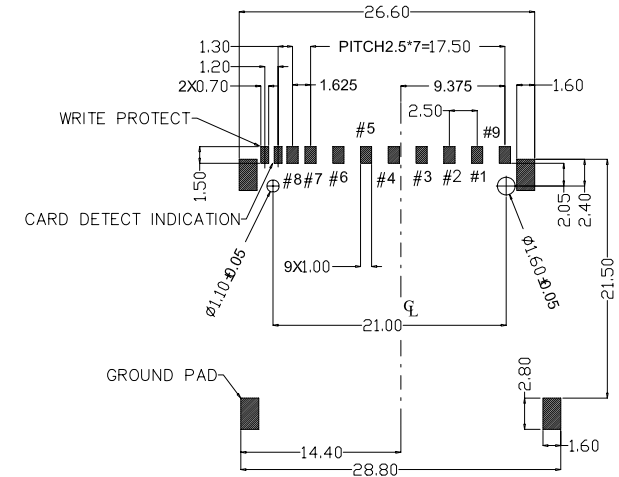

RECOMMENDED PCB LAYOUT

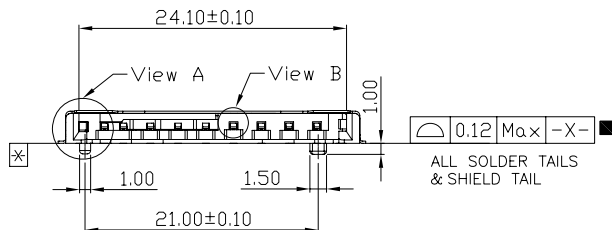

TOLERANCE (UNLESS SPECIFIED)		MAT'L	See Note		豪國興業股份有限公司				
(UNLESS SPECIFIED)		FINISH	See Note						
mm	LINEAR	0.0	±0.20	DATE	SCALE	TITLE:			
		0.00	±0.10				2008.06.18	1/1	SD MANUAL TYPE CONN.
		0.000	±0.05						
INCH	ANGLES			PART NO.	APP. BY	DWG. NO.			
	RADIUS						SDMA-71001-00X00	田耀鋒	SDMA-71001-00X00
DR. BY	CHK. BY	APP. BY			DWG. NO.	SHEET			
盛有功	田耀鋒	田耀鋒			SDMA-71001-00X00	1/1			
				REV.	UNIT	mm			
				B					